



CLYDE MARINE SERVICES LTD



SINGLE SCREW TUG / WORKBOAT

BOOJUM BAY

GENERAL

DELIVERY DATE	1965
BASIC FUNCTIONS	Towing, and pushing
CLASSIFICATION	MCA Workboat Code Cat 3

DECK LAY-OUT

ANCHOR	1 X 75 kg Piool
CHAIN (TOT.)	200 m shortlink 16 mm
TOWING HOOK	SWL 50 kN

DIMENSIONS

LENGTH O.A.	15.7 m
BEAM O.A.	4.6 m
DEPTH AT SIDES	2.2 m
DRAUGHT AFT	1.8 m
DISPLACEMENT	65 Te
GRT 50.	30

ACCOMMODATION

Accommodation for 2 persons, consisting of one cabin, a galley, and sanitary facilities. The Vessel is suited to transport 12 passengers.

TANK CAPACITIES

FUEL OIL	5.4 m ³
FRESH WATER	1.0 m ³

NAUTICAL AND COMMUNICATION EQUIPMENT

RADAR SYSTEM	Furuno MD3400
COMPASS	Sestrel
VHF	Sailor RT2048
SEARCHLIGHT	Francis

PERFORMANCES (TRIALS)

BOLLARD PULL AHEAD	5.0 Te
SPEED	9.5 knots

PROPULSION SYSTEM

MAIN ENGINES	1 X Kelvin TS8 (turbocharged)
TOTAL POWER	239 kW (320 bhp)
GEARBOXES	Kelvin 3½ : 1
PROPELLERS	1x Bronze fixed pitch
NOZZLES	Fixed



CLYDE MARINE SERVICES LTD

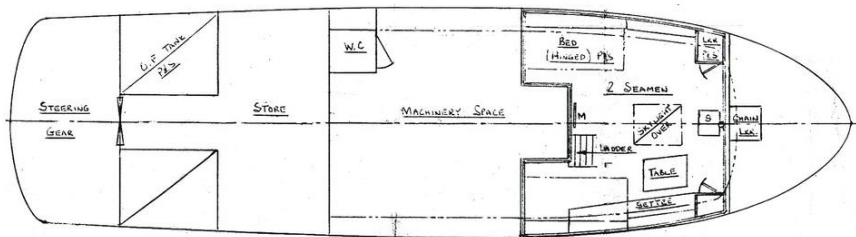
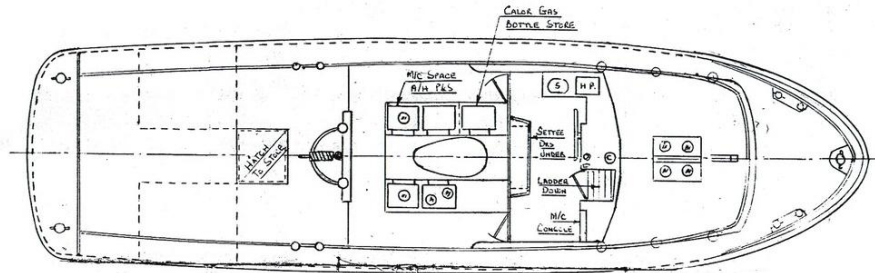
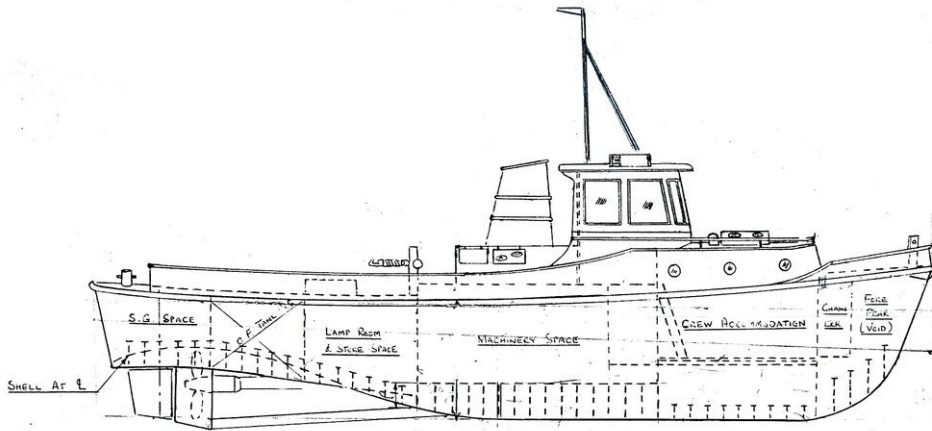

CONTACT DETAILS

CLYDE MARINE SERVICES LTD

Victoria Harbour,
GREENOCK,
PA15 1HW
SCOTLAND

Tel: 01475 721281

Fax: 01475 888023

Email: hamish.munro@clyde-marine.co.uk

www.clyde-marine.co.uk