

CLYDE MARINE SERVICES LTD



TWIN SCREW TUG / WORKBOAT

BATTLE

GENERAL

DELIVERY DATE	October 2004
BASIC FUNCTIONS	Towing, mooring and pushing
CLASSIFICATION	MCA Workboat Code Cat 2

DIMENSIONS

LENGTH O.A.	19.50 m
BEAM O.A.	6.04 m
DEPTH AT SIDES	2.70 m
DRAUGHT AFT	2.59 m
DISPLACEMENT	129 ton
GRT	50.49

TANK CAPACITIES

FUEL OIL	24.1 m ³
FRESH WATER	2.4 m ³
WATER BALLAST	1.9 m ³
SEWAGE	0.8 m ³
SLUDGE	0.5 m ³

PERFORMANCES (TRIALS)

BOLLARD PULL AHEAD	20.8 ton(m)
SPEED	11.7 knots

PROPULSION SYSTEM

MAIN ENGINES	2x Caterpillar 3412C TA/B
TOTAL POWER	1074 bkW (1440 bhp) at 1800 rpm
GEARBOXES	2x Reintjes WAF 364L 1: 4.92
PROPELLERS	2x Bronze fixed pitch Promarin
NOZZLES	2x 1500 mm van de Giessen Optima

AUXILIARY EQUIPMENT

GENERATOR SET	Lister Petter DWS 4
CAPACITY	29 kVA, 50 Hz, 230/400 V, 3 phase
CENTRAL HEATING	Kabola, oil fired boiler

DECK LAY-OUT

ANCHOR	2 x 105 kg Piool (High Holding Power)
CHAIN (TOT.)	200 m shortlink 16 mm U2/Q2
ANCHOR WINCH	Hand operated, Rek & Horsman
TOWING HOOK	Mampaey, SWL 250 kN

ACCOMMODATION

Accommodation for 5 persons consisting of one 4 persons cabin and one single cabin, a galley and sanitary facilities. The Vessel is suited to transport 12 passengers, seated in the wheelhouse.

Secure single berth clients office, equipped with desk, bookshelves and 240v sockets.

NAUTICAL AND COMMUNICATION EQUIPMENT

RADAR SYSTEM	Koden MDC-1041
COMPASS	Magnetic, Cassens & Plath, Kotter type
VHF	Sailor RT4822
HANDHELD VHF	Motorola 340
CHART PLOTTER	Koden, GPS track display GTD-110
SEARCHLIGHT	24 V 250 W Pesch



CLYDE MARINE SERVICES LTD

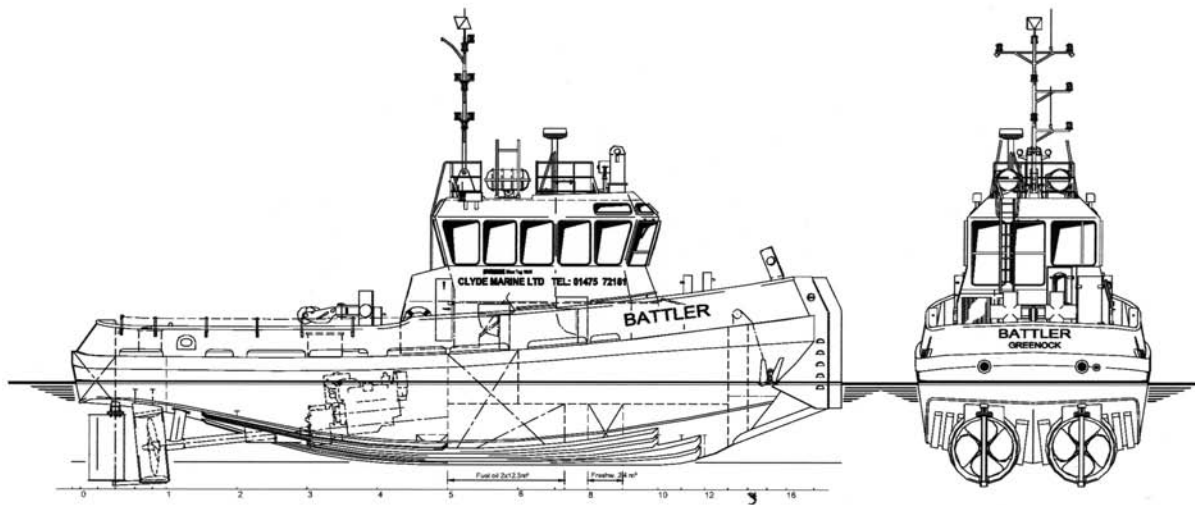

Maindeck

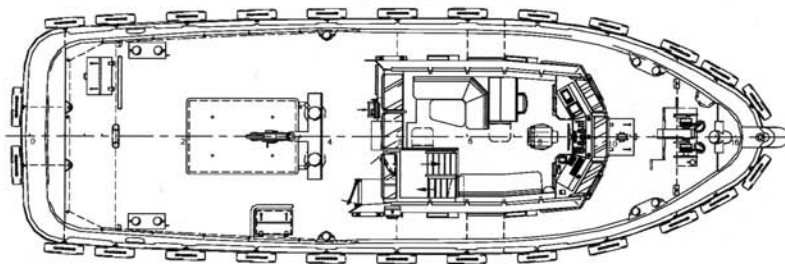

Topdeck

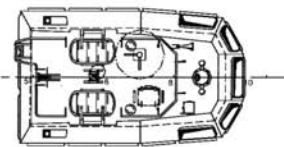

Below Maindeck

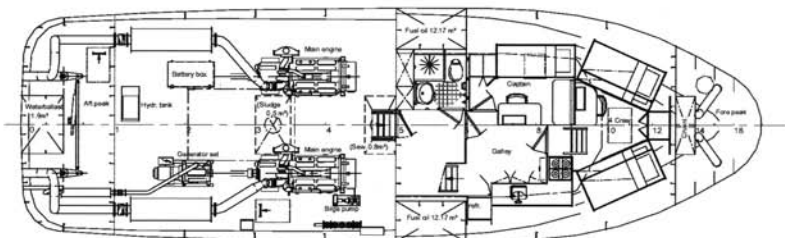

CONTACT DETAILS

CLYDE MARINE SERVICES LTD

Victoria Harbour,
GREENOCK,
PA15 1HW
SCOTLAND

Tel: 01475 721281

Fax: 01475 888023

Email: hamish.munro@clyde-marine.co.uk

www.clyde-marine.co.uk